

STEALTH CONFERENCE TABLE ASSEMBLY

2 BASE CONFIGURATIONS



FULL BASE ASSEMBLY

TOOLS REQUIRED:

#2 PHILLIPS SCREWDRIVER, OR DRIVER BIT WITH POWER TOOL

½" COMBINATION WRENCH

FASTENERS INCLUDED IN HARDWARE PACK:

5/16-18 FLANGE NUTS ATTACHED TO 90° CORNER BRACKET

#1 SCREW

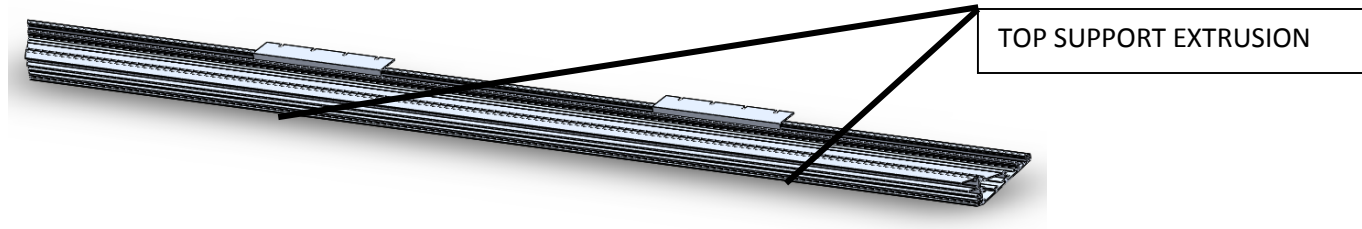
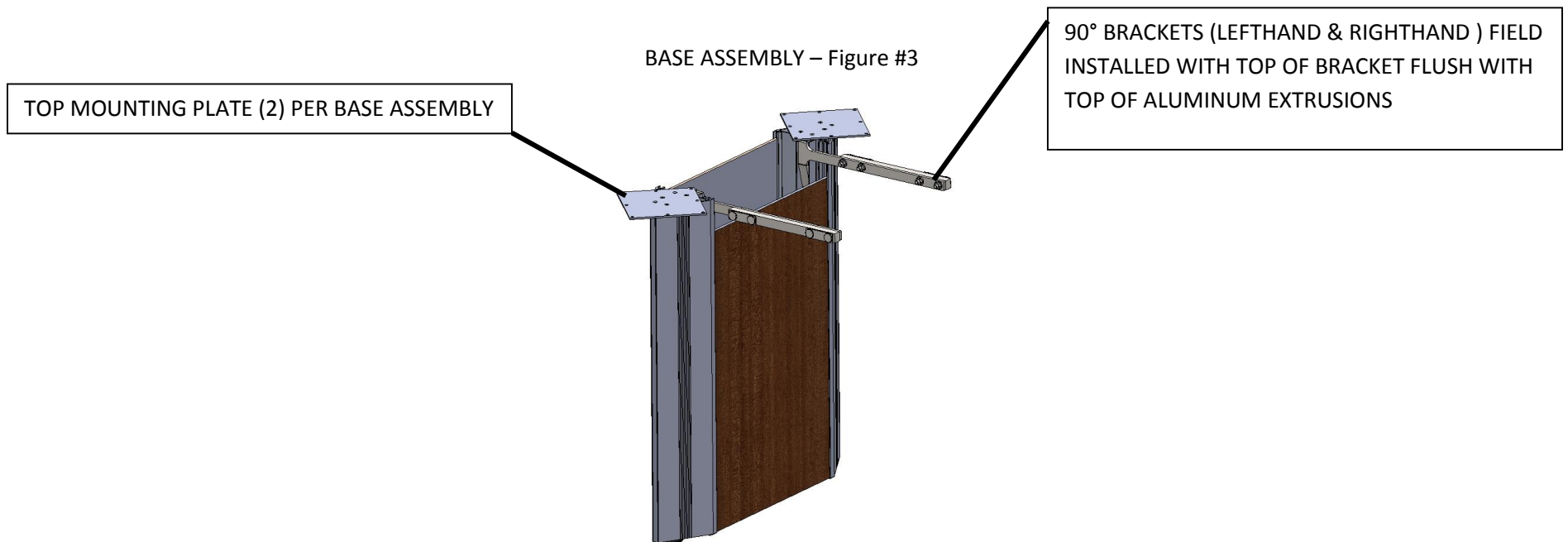

FIGURE #2 - EXTRUSION BEAM

DEPENDING UPON BEAM LENGTH THE NUMBER OF TOP SUPPORT EXTRUSIONS WILL VARY. THEY SHOULD BE EVENLY SPACED BETWEEN EXTRUSIONS AND $\frac{1}{2}$ THE DISTANCE FROM THE EXTRUSION TO THE BASE ASSEMBLY



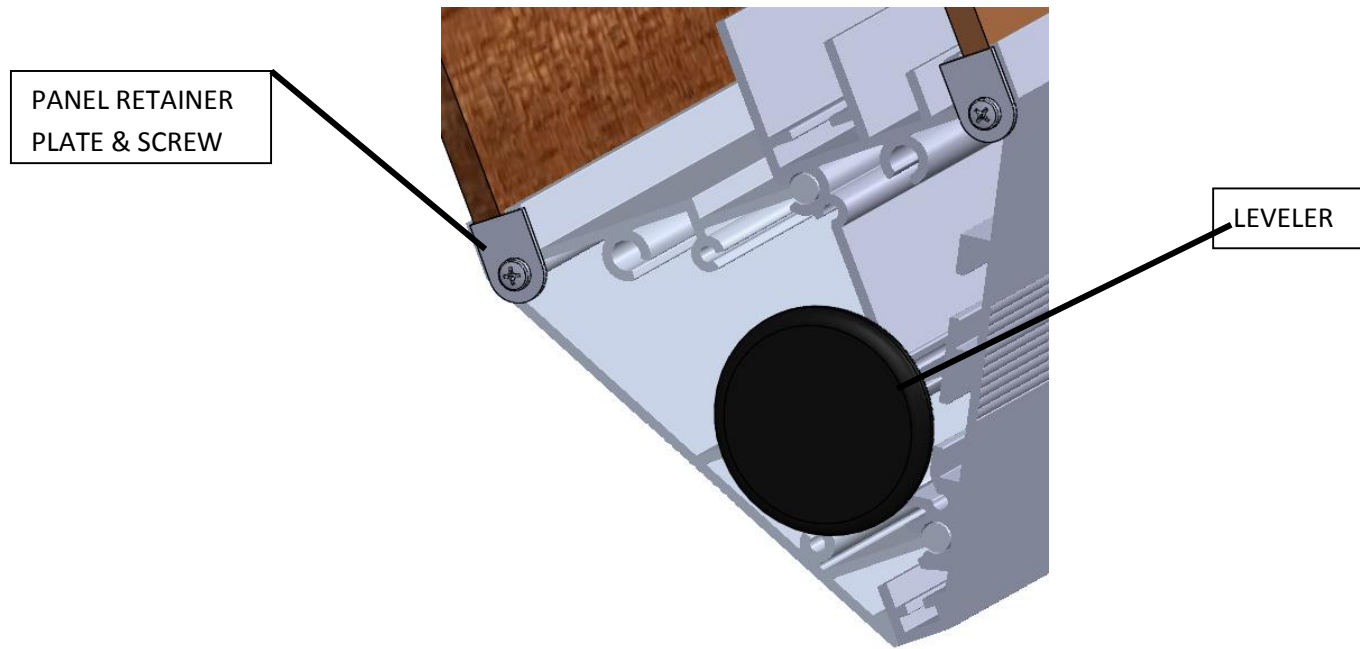

FIGURE #5

NOTE PANEL RETAINER PLATE, SCREWS AND LEVELERS ARE INSTALLED AT THE FACTORY. LEVELERS SHOULD BE ADJUSTED AS NEED TO LEVEL TABLE BASE ASSEMBLY PRIOR TO INSTALLING TABLE TOP

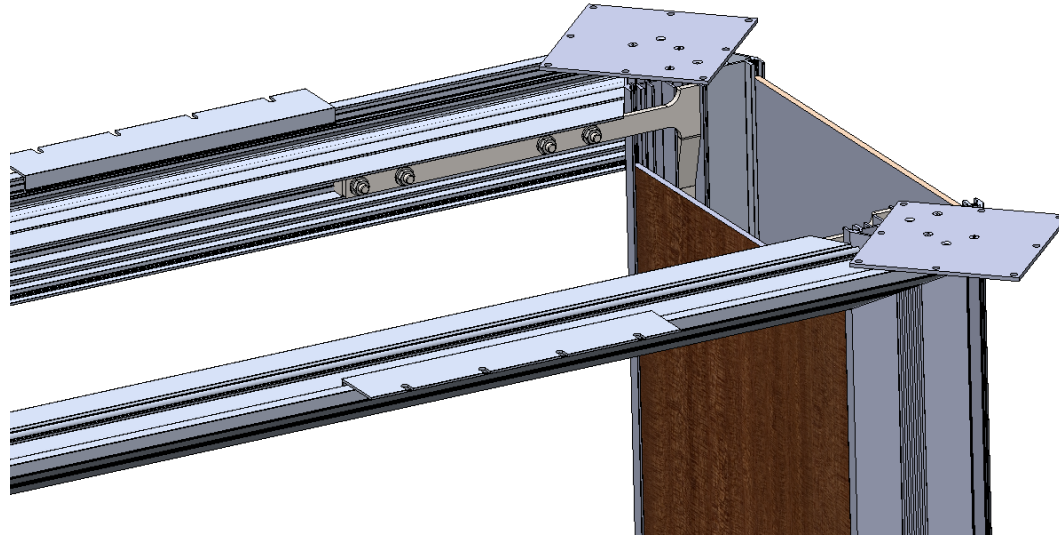

FIGURE #6

INSERT EXTRUSION ON TO BOLT PLATE, BOLT PLATE SHOULD SLIDE INTO CHANNEL IN EXTRUSION (SEE FIGURE #7)

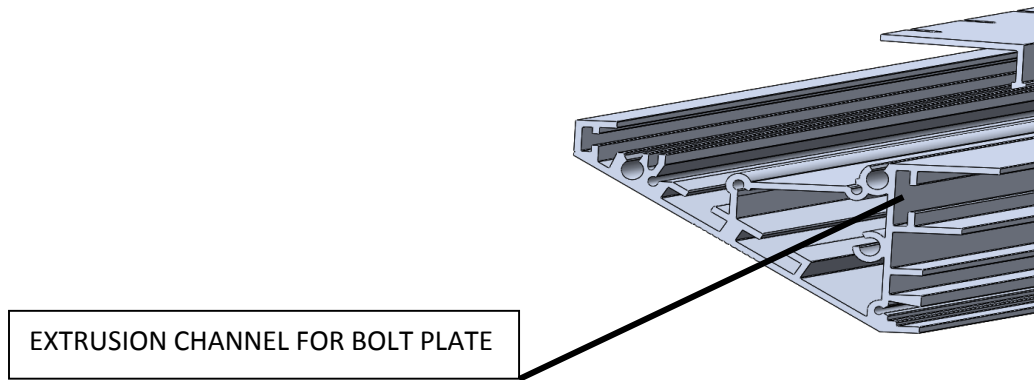

FIGURE #7

REPEAT PROCESS FOR OPPOSITE EXTRUSION, CONTINUE WITH THE OPPOSITE BASE. ONCE THE EXTRUSIONS ARE ATTACHED TO THE TWO BASES MAKE SURE THAT THE TOP SUPPORT EXTRUSIONS (SEE FIGURE #2) ARE LEVEL WITH THE MOUNTING PLATE (SEE FIGURE #3). TIGHTEN ALL FLANGE NUTS SECURELY USING A ½” WRENCH

PLACE TOP ON BASE ASSEMBLY AND CENTER SIDE TO SIDE AND FRONT TO BACK, OVERHANG ON THE ENDS VARIES DEPENDING UPON SIZE OF TOP SEE CHART FOR APPROXIMATE OVERHANG DISTANCE.

STEALTH TABLE BASE CONFIGURATION		
Table Size - inches	Overhang - inches	No. of Supports
72	15.375	2
84	15.375	2
96	15.375	2
108	20.375	2
120	20.375	2
132	20.375	2
144	20.375	2
156	20.375	2
168	20.375	2